

Ground Floor Plan of Satellite Building

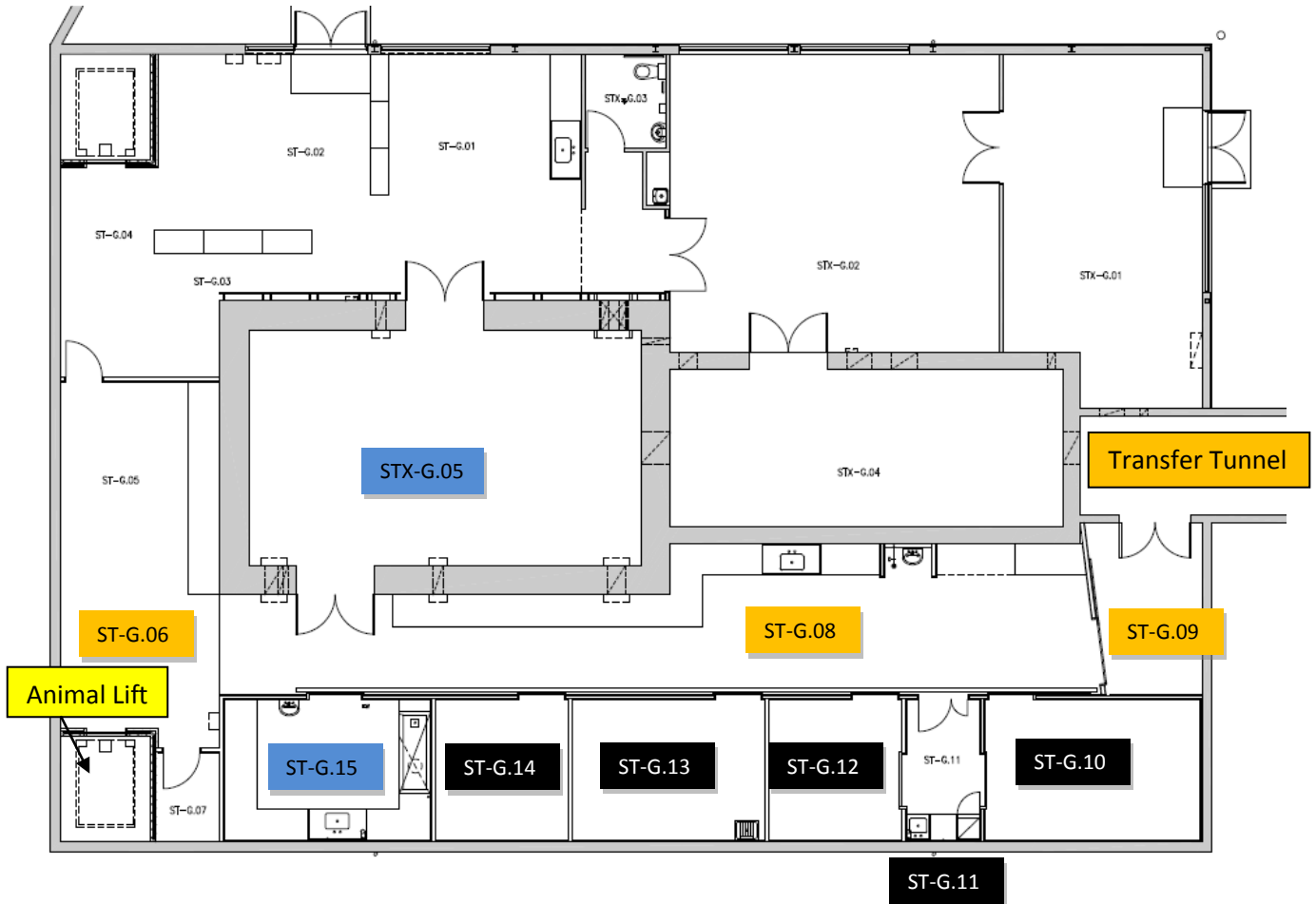

Animal Holding Rooms:

ST-G.10	PC1 Holding Room 1
ST-G.11	PC1 antechamber
ST-G.12	PC1 Rodent Room 2
ST-G.13	Large Animal Room 3
ST-G.14	Rodent Room 4

Animal Transfer Corridors & Lift:

Animal Lift (Western Corner) & ST-G.06	Animal Lift and surrounds
ST-G.08	Animal Holding Corridor
ST-G.09 & Transfer Tunnel (NBX-G.14)	Antechamber & Tunnel

Animal Procedures Rooms:

ST-G.15	Surgery 1
STX-G.05	3B Hutch

First Floor Plan of Satellite Building

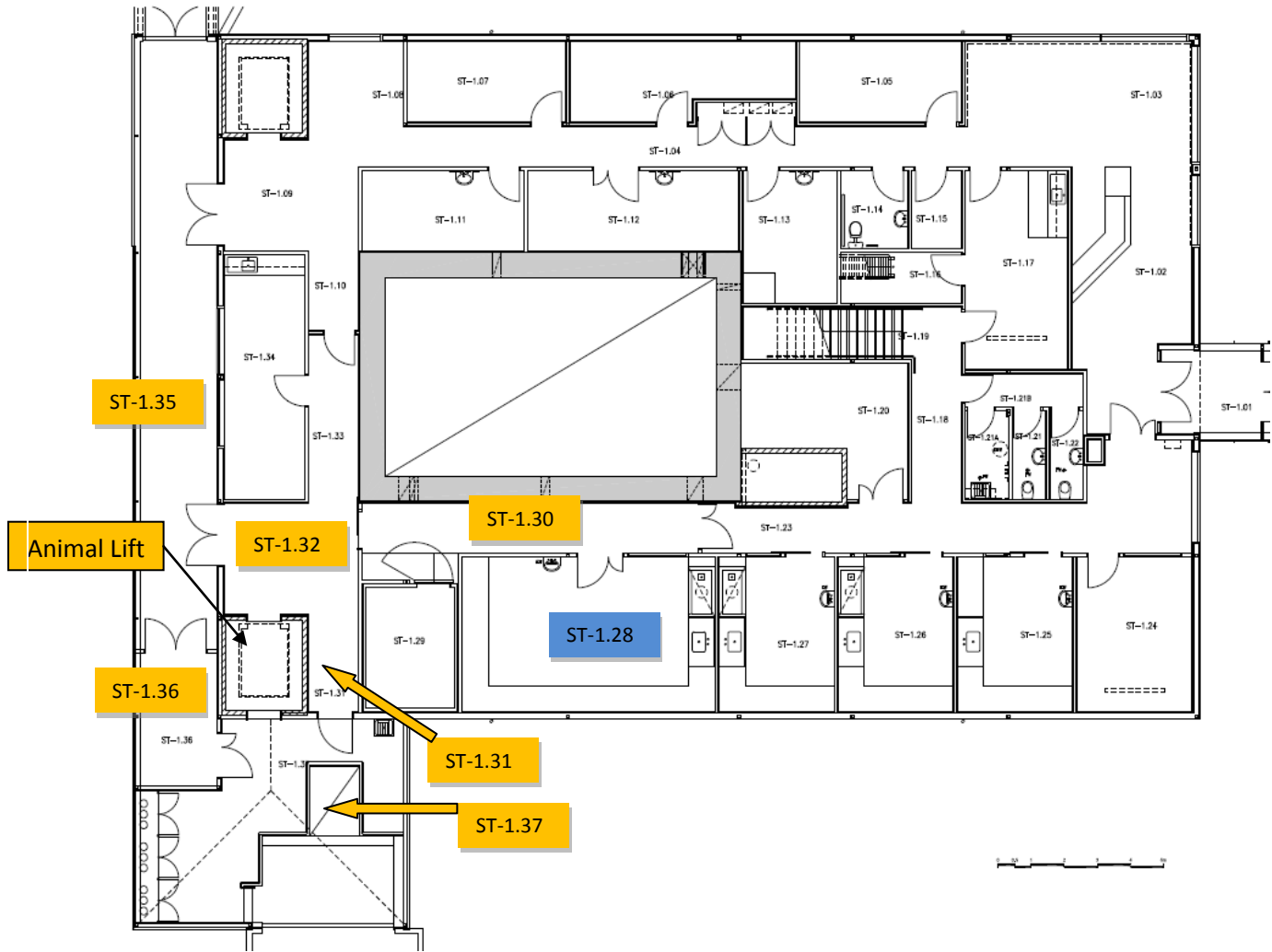

Animal Lift and Transfer Corridors:

Animal Lift & ST-1.32	Animal Lift and Delivery Corridor
ST-1.31 & ST-1.37	Delivery door and Loading Dock
ST-1.35	IMBL-MBI link corridor
ST-1.36	Trolley Bay (and continuation of link corridor)
ST-1.30	Surgery corridor

Animal Procedure Room:

ST-1.28	Surgery 2
---------	-----------

Ground Floor Plan of Near Beam Surgery/Preparation Area



Animal Transfer Corridors:

NBX-G.14 & NB-G.14	Transfer Tunnel and antechamber 2
NB-G.11 & NB-G.10	Corridor & Control Area
NB-G.09	1B corridor

Animal Procedures Rooms:

NB-G.12	NBSPA Surgery and short-term rodent holding
NBX-G.13	2B Hutch
NBX-G.11	1B Hutch
NB-G.05	Preparation Room